

**MUSEO
NAZIONALE
SCIENZA
E TECNOLOGIA
LEONARDO
DA VINCI**

**MU
ST LOCATION**
MUSEUM EVENT VENUES

THE MUSEUM

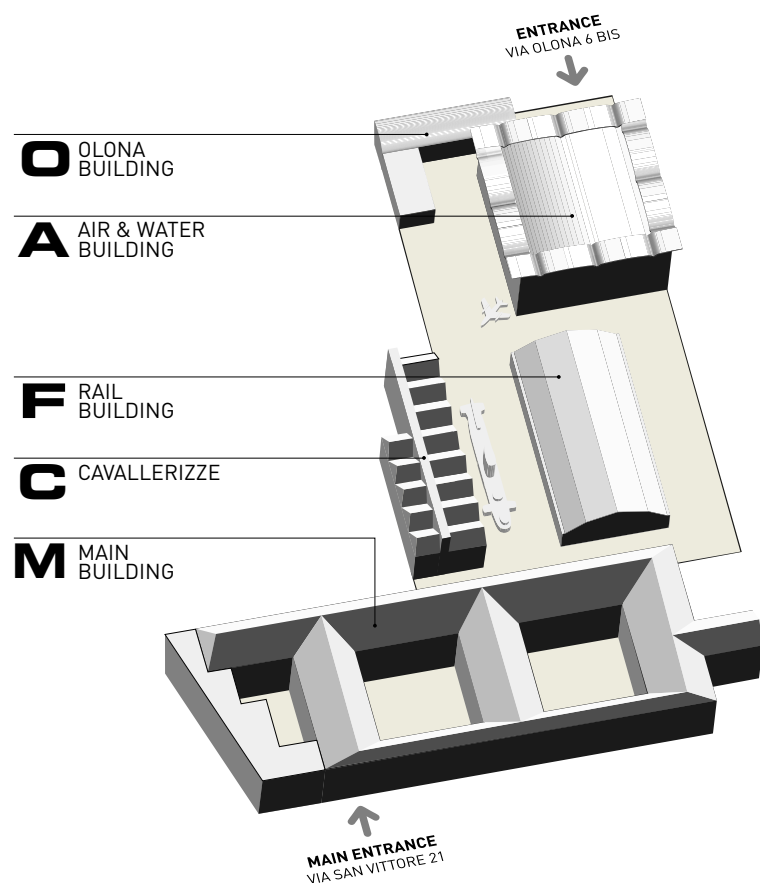

Dedicated to Leonardo da Vinci, the Museum of Science and Technology, is located in the heart of Milan. It is the largest science and technology museum in Italy. The unique atmospheres of the ancient monastery, of the Rail Transport Building and of the Air & Water Transport Building turn it into an exceptional location for memorable events.

The historical spaces of the Museum are ideal for conferences, presentations, product launches, gala dinners, performances and fashion shows, but also to tell stories and leave space for creativity through exhibitions, shootings and movie sets.

Evocative trails, guided tours to the Leonardo Gallery, the Toti submarine and thematic exhibitions, offer guests an unforgettable experience bridging history and modernity, art, science and technology.

The Staff of the Museum Events Office will be delighted to support you in the study and design of your customized event.

FOR MORE INFORMATION

+ 39 0248555 441 / 445 / 324 / 356

eventi@museoscienza.it

www.museoscienza.org/mustlocation

 @MUSTlocation

CAVALLERIZZE

C

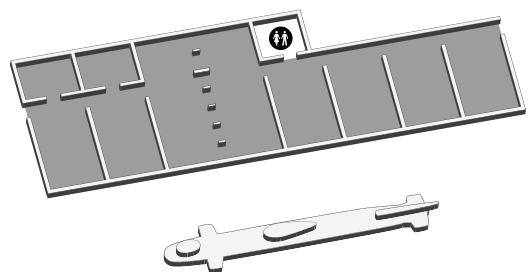

Placed alongside the submarine Enrico Toti, between the Monumental building and the Air&Water Transport Building, the Cavallerizze (historical stables) are the result of a recent restoration process, in the context of contemporary urban redevelopment.

Built in the 1800s after the Olivetan monastery was turned into barracks, the space is characterised by large open volumes, evocative bare brick walls and large luminous windows. The space is suitable for large scale events, exhibitions and conferences.

AREA 1600 sq.m.



CHIOSTRI

M¹

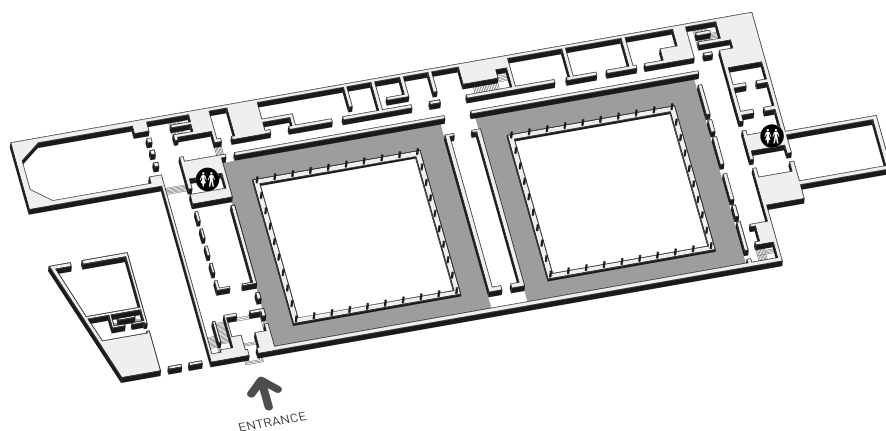

Located on level 1 of the Monumental Building, the two twin cloisters preserve the ancient beauty of the sixteenth century monastery. Overlooking two gardens and dominated by the steeple of the San Vittore church, the cloisters give the chance to enjoy discreet social events in a secret corner of Renaissance Milan.

AREA 715 sq.m. each cloister
The Cloisters are outdoors but sheltered from the rain



AUDITORIUM

M¹

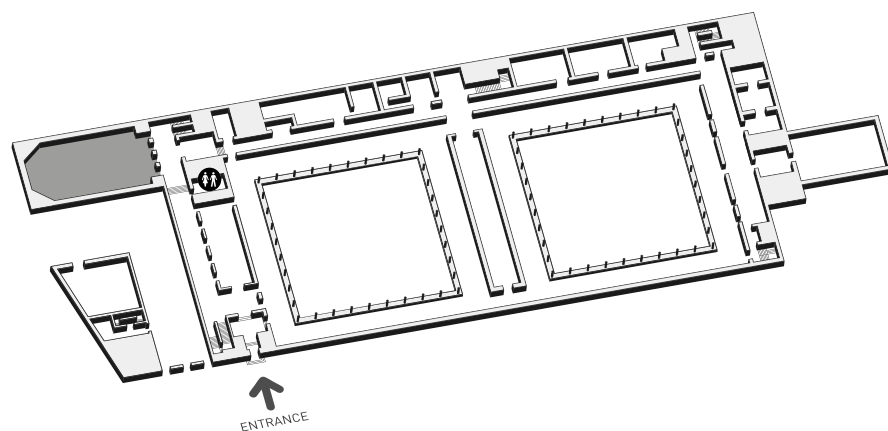

In this renovated multipurpose space, located on level 1 of the Monumental Building, the elegance of the 1950s original structure is enhanced by modern technical equipment and furnishings. It represents an ideal setting for conferences, seminars and cultural activities. Next to the entrance is the Regina Margherita space, which can comfortably host coffee breaks and cocktails.

STAGE 8.50 × 3.50 m
SCREEN 8.70 × 3.70 m
CAPACITY 234 seats

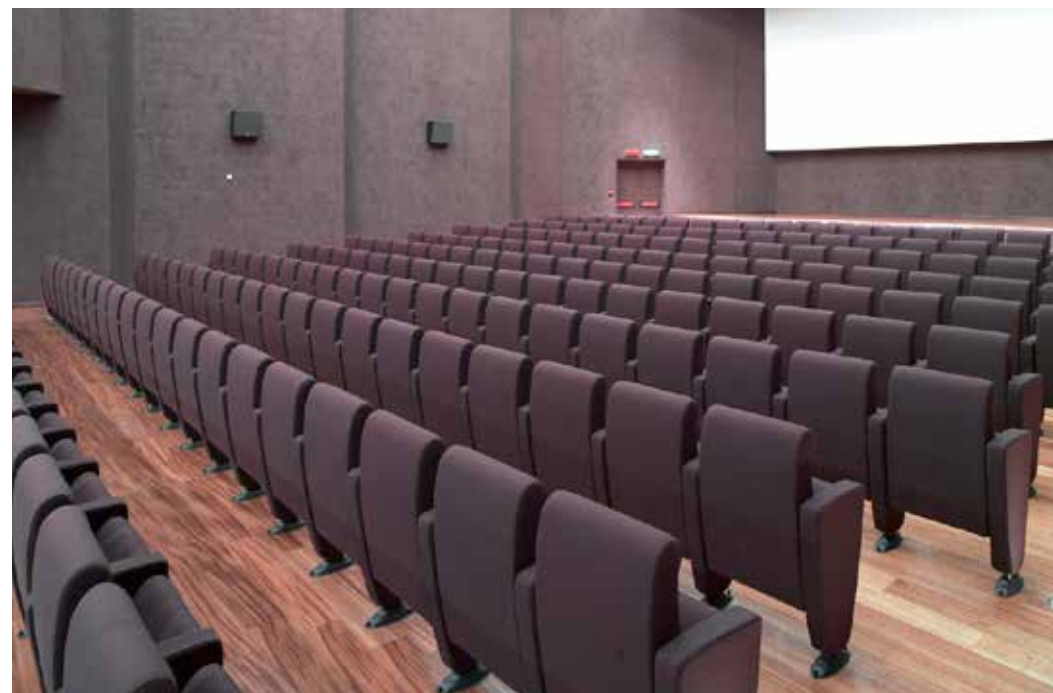

SALA DEL CENACOLO

M¹

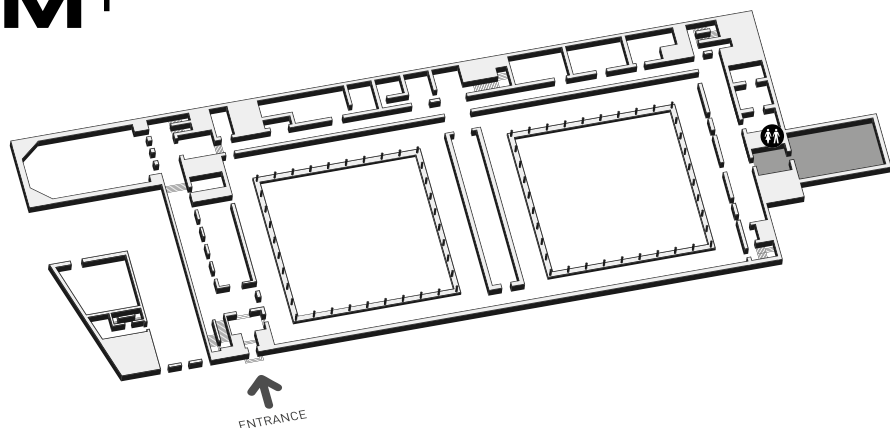

Located on level 1 of the Monumental Building and overlooking the cloister, the ancient refectory of the monastery is entirely decorated with stucco and frescoes by Pietro Gilardi, evoking the baroque splendour of the eighteenth century.

The impact of colours and details creates the ideal atmosphere for inspiring events. The area in front of the hall, known as Anticenacolo, can host coffee breaks and cocktails.

AREA 220 sq.m.
CAPACITY 90 people



TINKERING ZONE

M¹

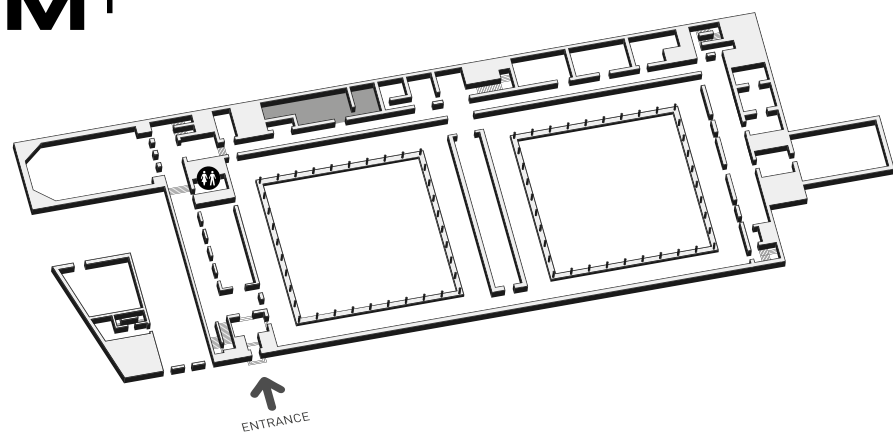

Located on level 1 of the Monumental Building, the Tinkering Zone is a workshop dedicated to the innovators of the future. Tinkering is a way to explore, understand and change the world. It is a method that works at the intersection between art and science, integrating technology, engineering and design. The space is suitable for workshops, press previews and small presentations.

AREA 85 sq.m.
CAPACITY 30 people



SALA DELLE COLONNE

M²

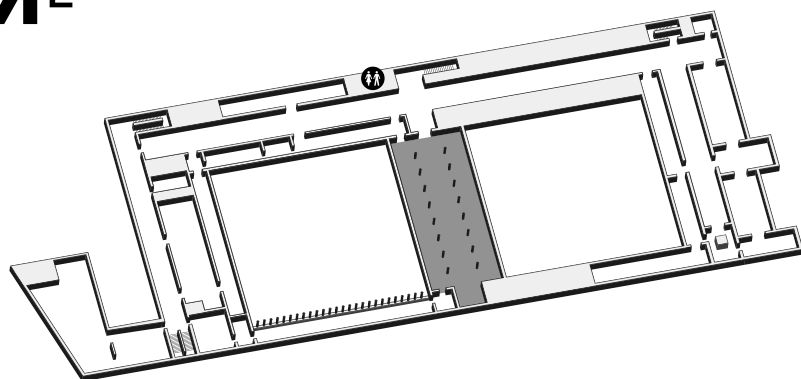

Located on level 2 of the Monumental Building, in the heart of the Galleria Leonardo, this was once the library of the Olivetan monastery. It is a fascinating hall, overlooking two beautiful Renaissance cloisters. The geometrical architecture, marked by a succession of arches and columns, makes this space ideal for hosting exhibitions and exclusive events.

AREA 600 sq.m.
CAPACITY 300 people



SALA DELLE COLONNE

TEMPORARY SET-UP

M²

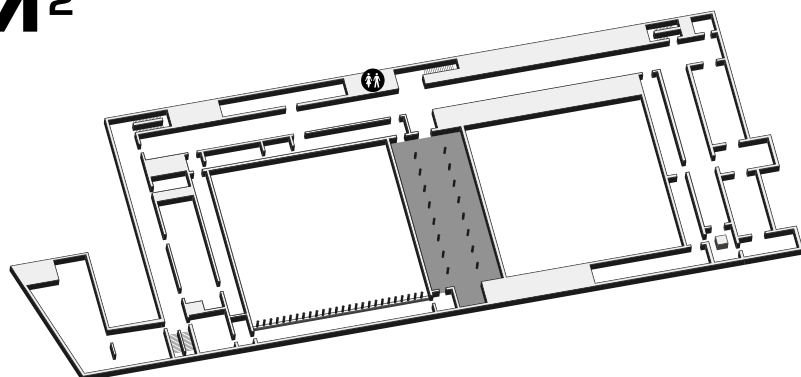

From 11.09.2018 to 28.02.2019 Sala Colonne will host a temporary set-up with 10 fascinating historical models of Leonardo da Vinci machines exhibited in the two side aisles. The central nave can be used as an evocative space for presentations or gala dinners.

AREA 600 sq.m.

CAPACITY 300 people in theater style

250 people in placé dinner



SALA MOSTRE

M²

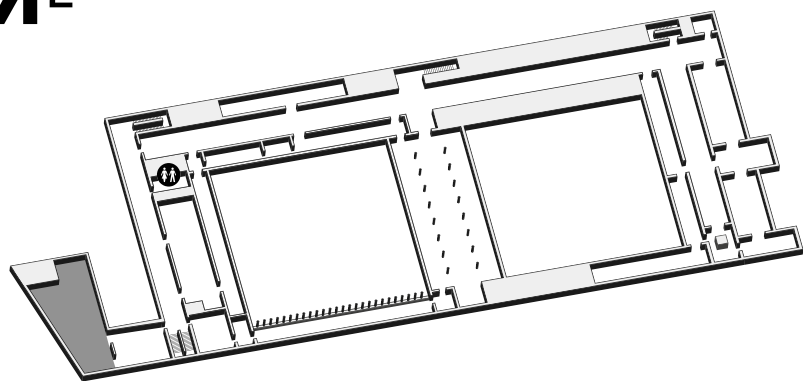

Located on level 2 of the Monumental Building, with access from Via San Vittore, this is a modular space ideal for exhibitions, product launches, screenings and performances.

AREA 350 sq.m.
CAPACITY 130 people



SPAZIO POLENE

A⁰

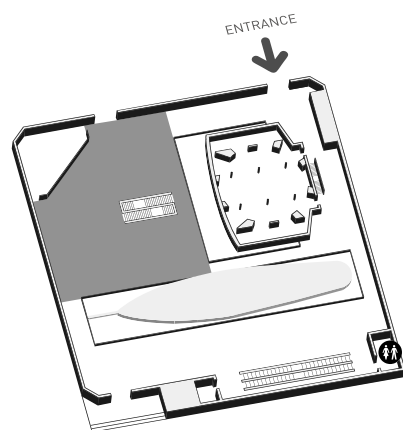

It is at the centre of the Air & Water Transport Building, dominated by beautiful figureheads and by the bridge-front of the ocean liner Conte Biancamano and AC72 Luna Rossa catamaran, with a dedicated entrance from Via Olona 6a. The Building, which houses some of the most important and fascinating objects of the Museum, offers a charming and picturesque setting for cocktails and appetizers.

AREA 500 sq.m.

CAPACITY 300 seated

700 standing (whole pavilion)



SALA CONTE BIANCAMANO

A⁰

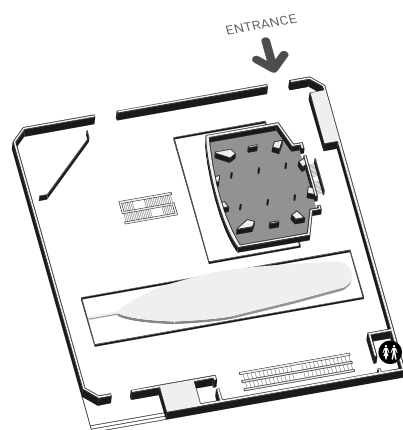

In the imposing setting of the Air & Water Transport Building, with a dedicated entrance from Via Olona 6a, is an impressive original sector of the ocean liner Conte Biancamano. Inside is this ballroom, with a peculiar circular shape that evokes the atmospheres of the 1930s. The space is ideal to host gala dinners and press conferences.

AREA 350 sq.m.
CAPACITY 100 people



EXHIBITION AREA A-1

A-1

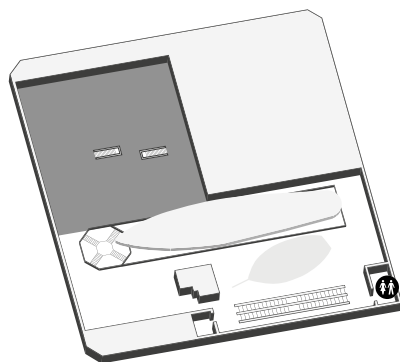

Located on level -1 of the Air & Water Transport Building, with direct access from the Spazio Polene, this is a modular space ideal for exhibitions, product launches, screenings and performances.

AREA 600 sq.m.



CULTURAL FACILITIES

To enrich the experience and amplify the enjoyment of the location, the museum offers guided tours of its collections, interactive workshops and Team Building activities.



TECHNICAL PARTNERSHIP

Hosting corporate events is not the only way in which MUST collaborates with companies and the territory. MUST, with its large and diverse audience (more than 450,000 visitors a year), is also an unique showcase for presenting products. Becoming MUST partners, contributing to the development and growth of the institution, enhances brand value and ensures international visibility.

MUST is always seeking to build new partnerships for the supply of indoor and outdoor furniture, lighting, signage and other accessories.

FOR MORE INFORMATION

+ 39 0248555 441 / 445 / 324 / 356

eventi@museoscienza.it

www.museoscienza.org/mustlocation

 @MUSTlocation
